

Integral Foam & Water Faucet-AC/DC AS8101-AD0500BF0



FEATURES

- Brass body
- Integral sensor Faucet/Soap Dispenser
- Foam soap
- Soap sensor distance: $9 \pm 2\text{cm}$;
- Faucet sensor distance: $20 \pm 5\text{cm}$
- AC 100-240V or DC 6V(4pcs D size battery)
- Standby energy consumption $<2\text{W}$; working energy consumption $<4\text{W}$
- Soap viscosity range: 1-20cp
- Water inlet: G1/2"
- Water pressure: 0.05-0.8MPa
- flow rate (L/min): 3-4.5, at 0.1MPa
- Soap volume $\leq 2\text{mLPF}$

SPECIFICATIONS

- Sensor installed at the spout
- Faucet Reach: 117mm
- Faucet Height: 220mm

DIMENSIONAL DRAWING

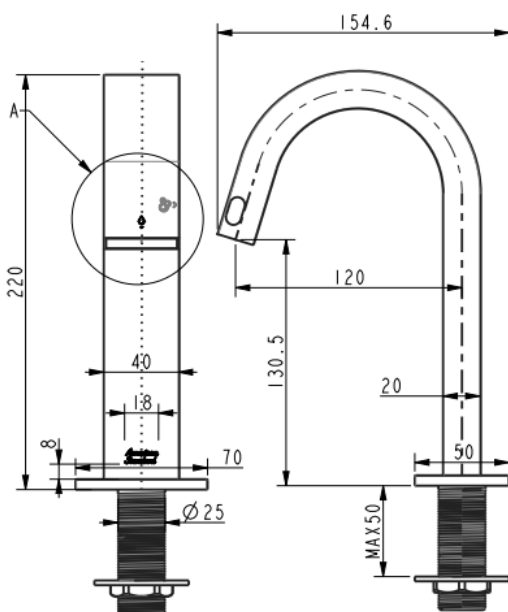

FINISHES AVAILABILITY

- Chrome (- CP)

AWARDS WON

- N/A

SHIPPING WEIGHT

- Product net weight: 3.1kg/set
- Product gross weight: 3.15kg/set

STANDARDS CRITERIA

- CJ/T 194-2014
- GB25501-2019

